

ESBE SERIES ARA600 3-Point

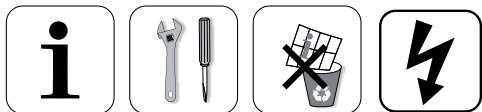

Series ARA6_1
Series ARA6_2
Series ARA6_3
Series ARA6_4

CE

LVD 2006/95/EC
EMC 89/336/EEC
RoHS 2002/95/EEC

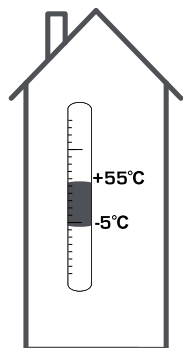

1

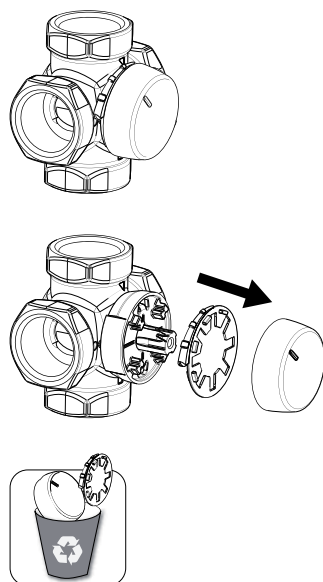

2

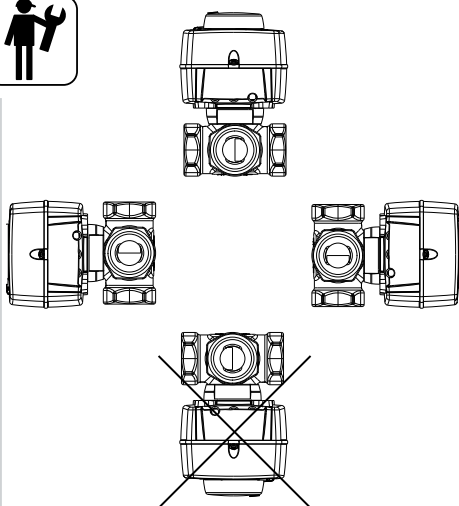

3



MG, G, F, H, HG, BIV, T, TM

	DN15-25	
	DN20-40	
	DN50	
	DN20-25	
	DN32-50	
	H: DN25	
	H: DN32-50	
	HG: DN25	
	DN20-22	
	DN25	
	T: DN20-32	
	TM: DN20	

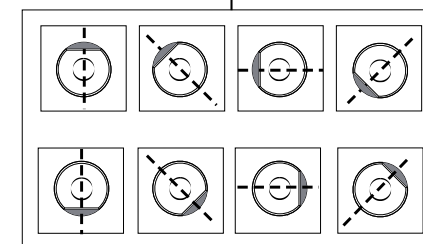
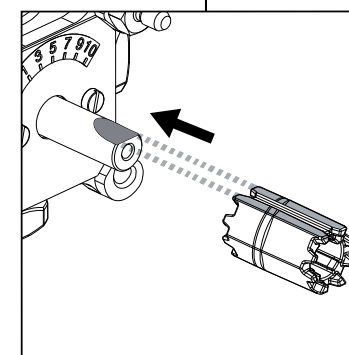
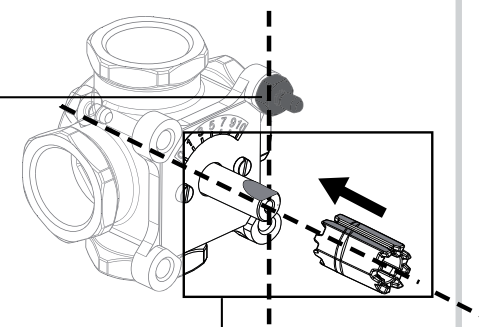

inocal
Wärmetechnik GmbH

i



**VRG130, VRG140, VRG230,
VRG330, VRB140**

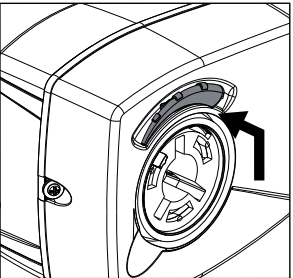
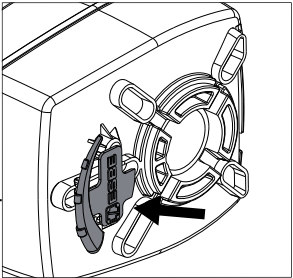
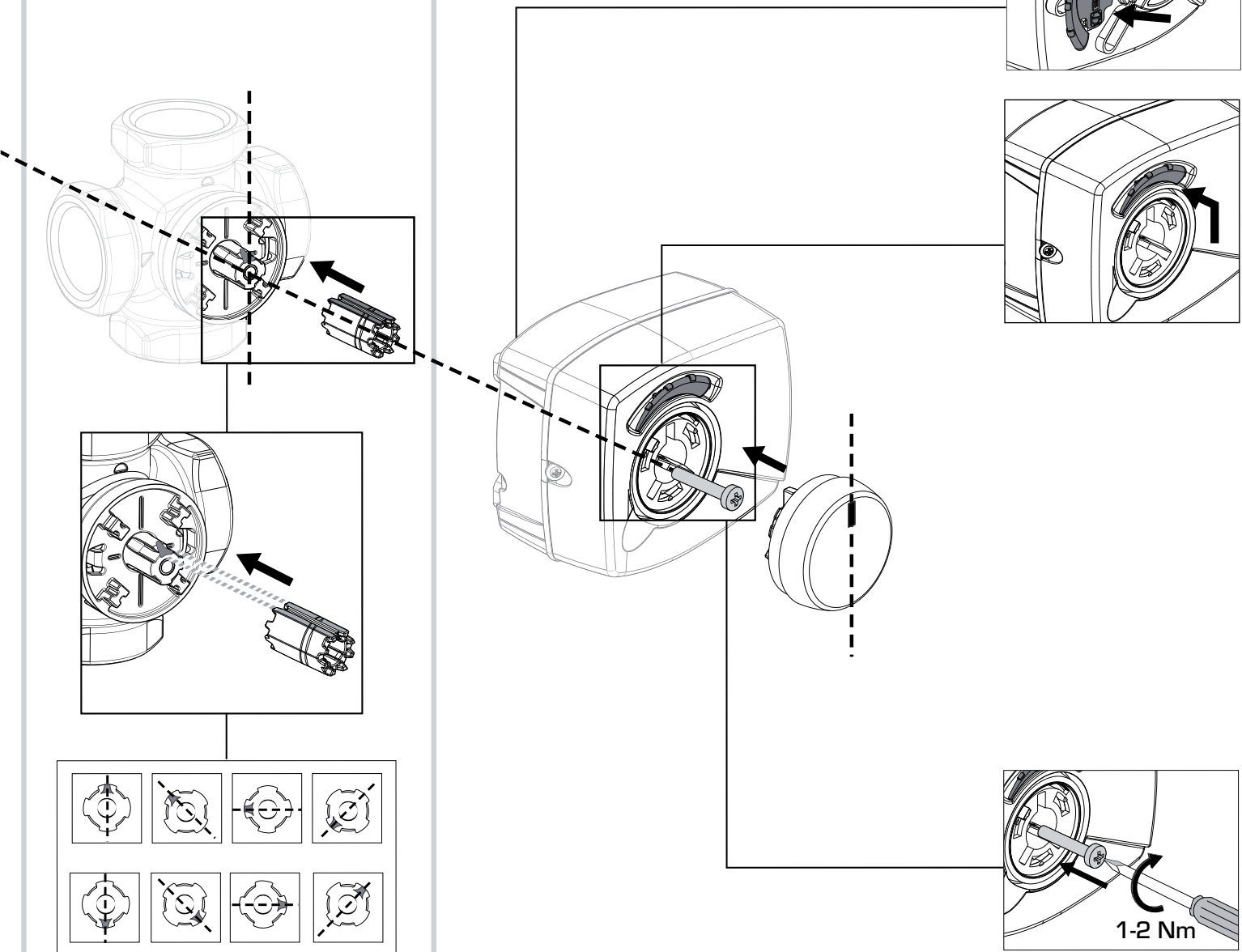

Mtrl.nr. 9814 02 75 • Ritn.nr. 8081 utg.E • Rev. 1008

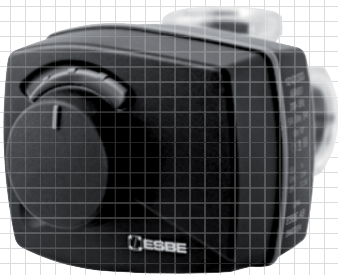

SERIES ARA600 3-Point



NO.1 IN HYDRONIC SYSTEM CONTROL

SERIES VRG130

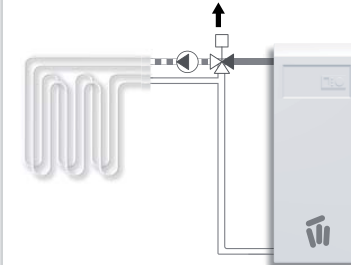
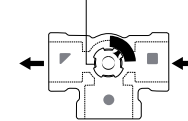
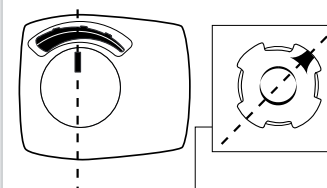
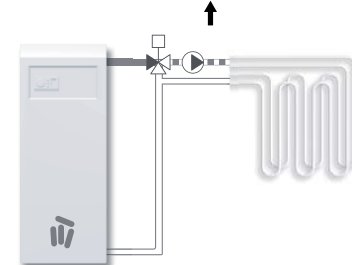
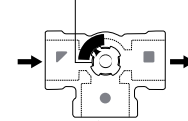
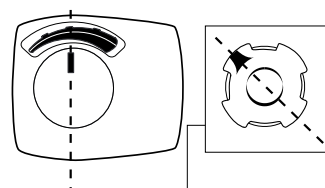
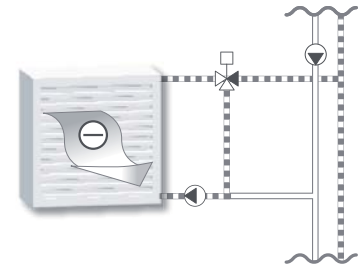
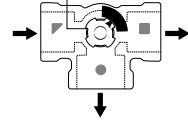
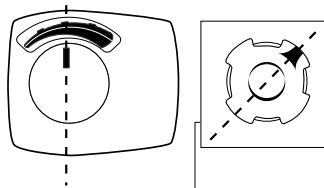
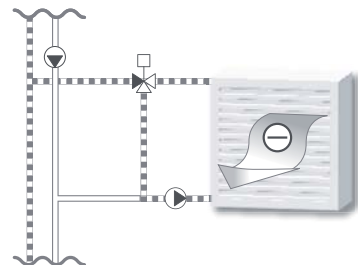
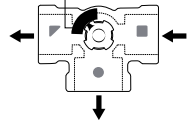
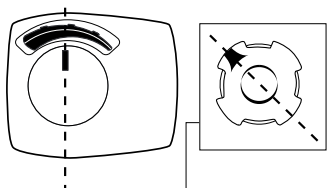
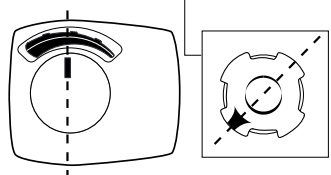
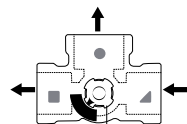
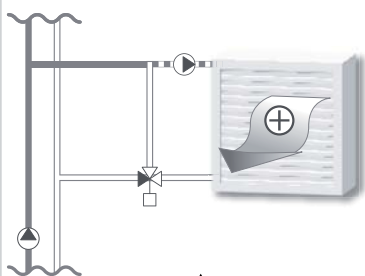
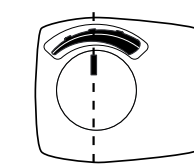
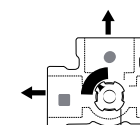
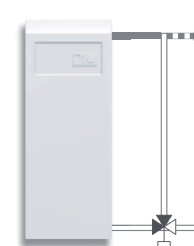
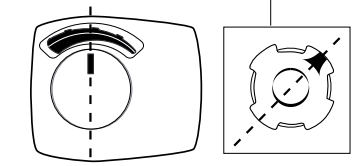
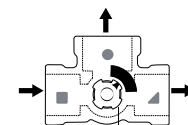
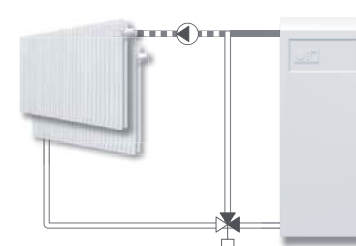
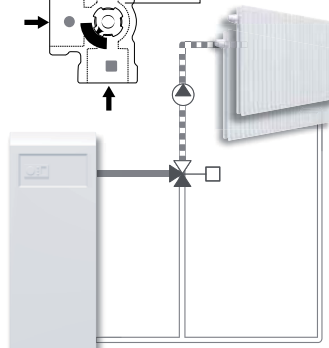
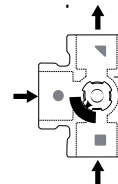
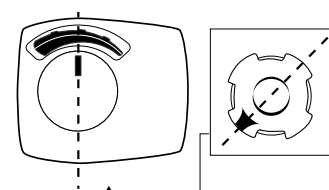
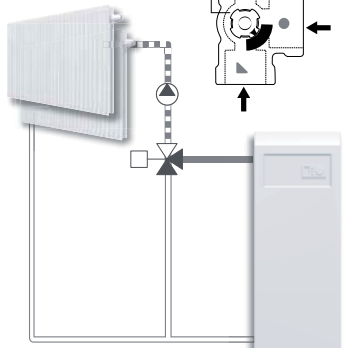
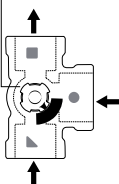
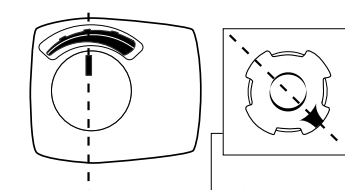
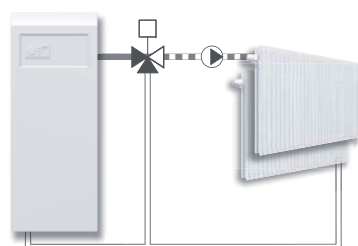
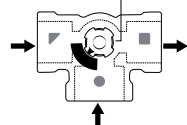
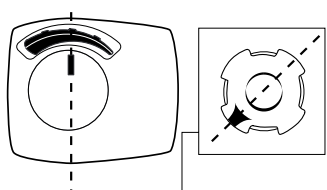
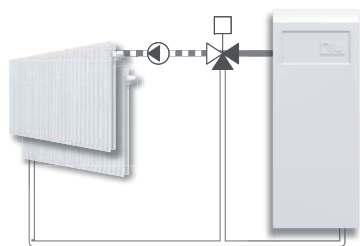
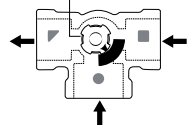
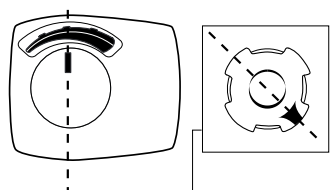

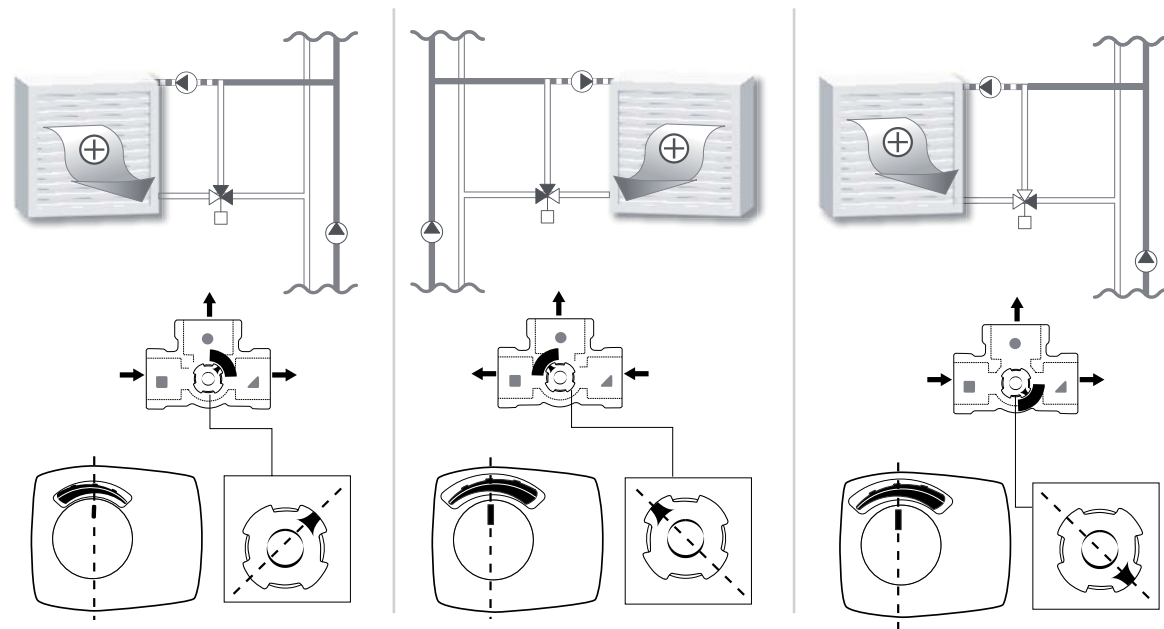
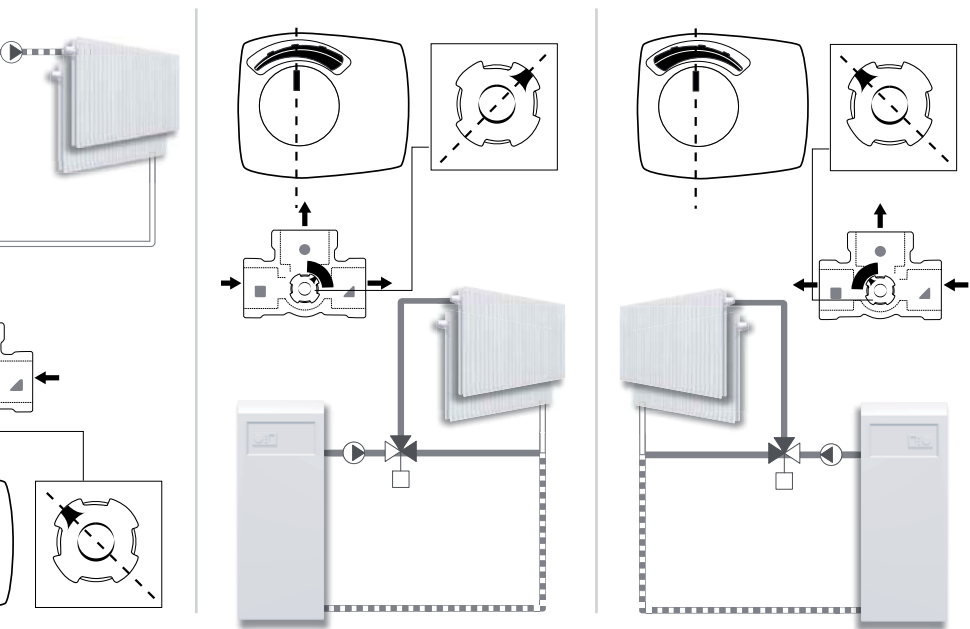

SERIES VRG130

SERIES VRG140

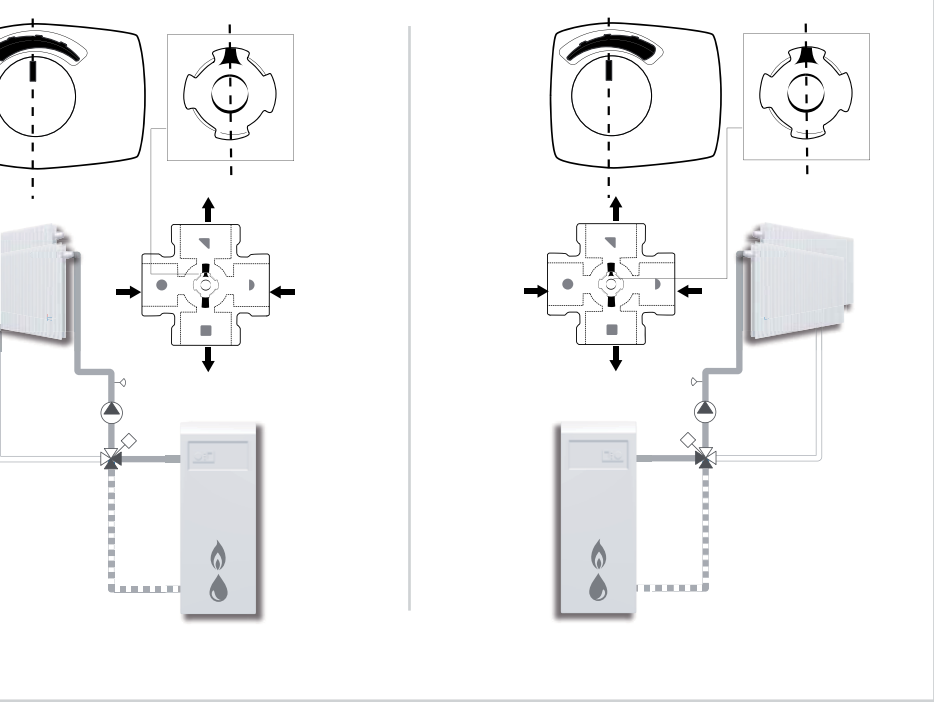

SERIES VRG230

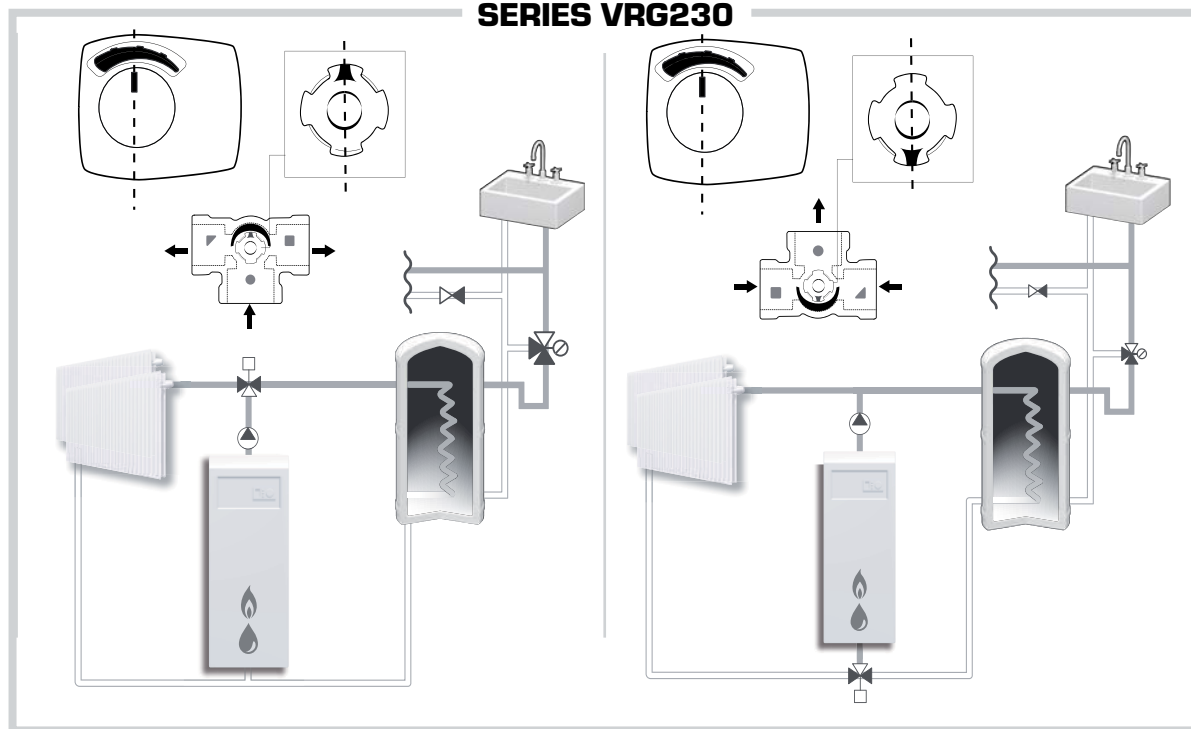

SERIES VRG330

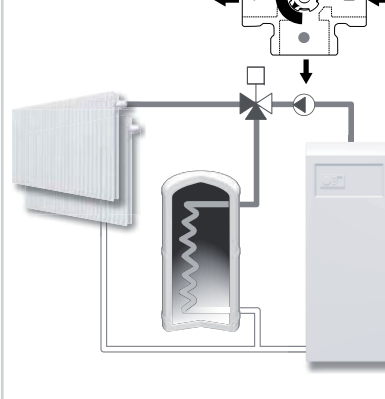
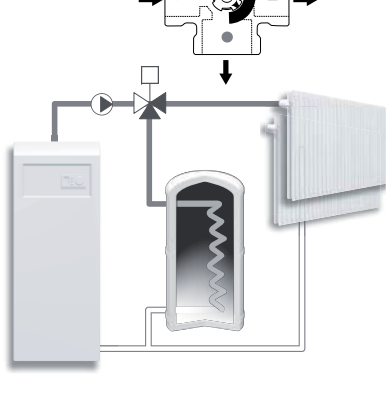
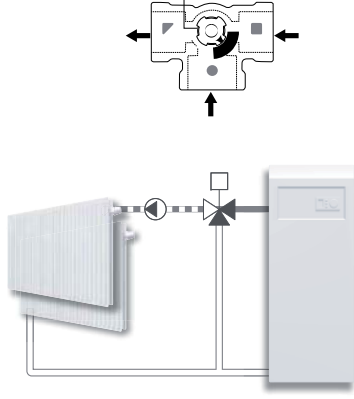
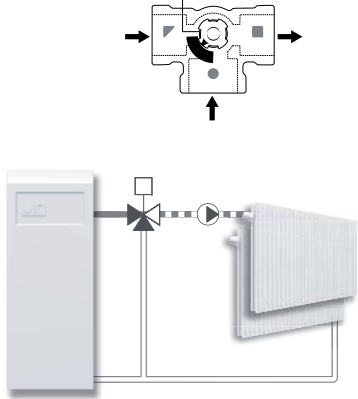
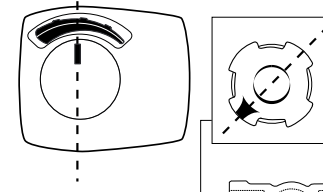
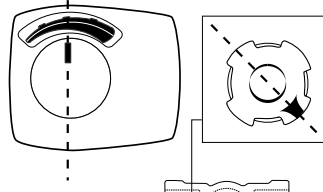
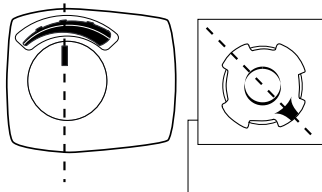
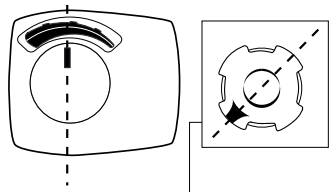

SERIES VRB140

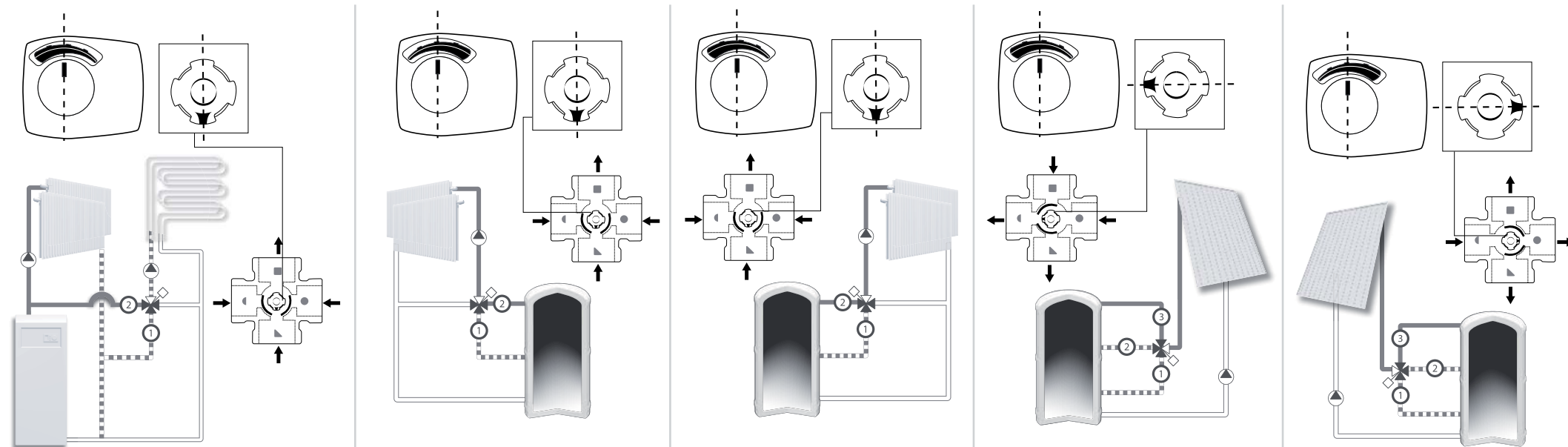
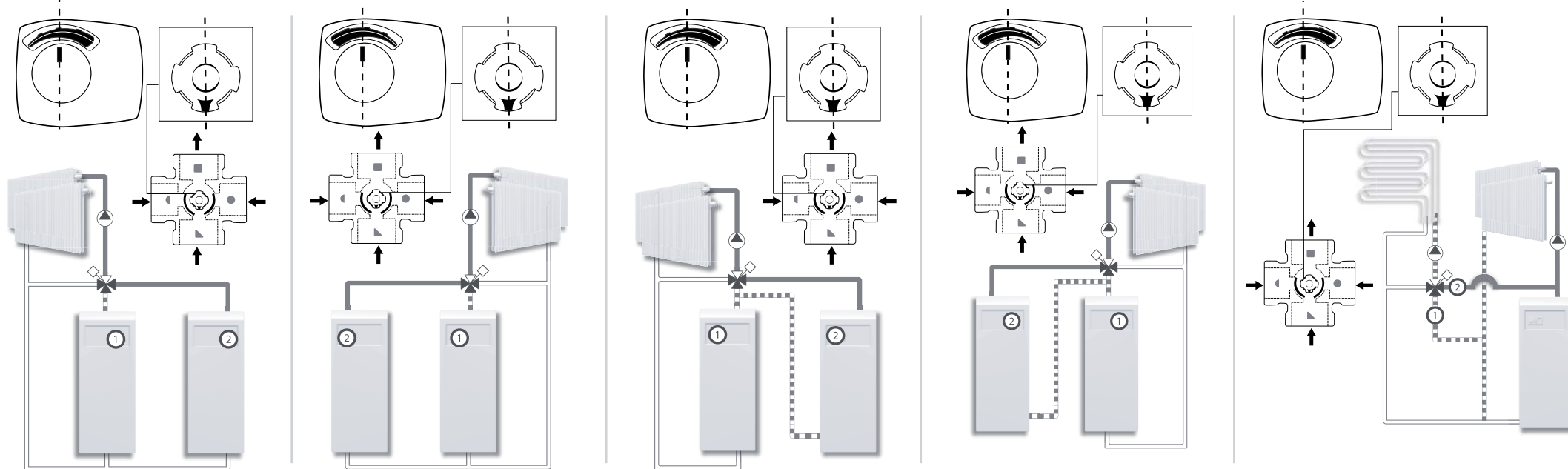



Series ARA6_1, ARA6_3

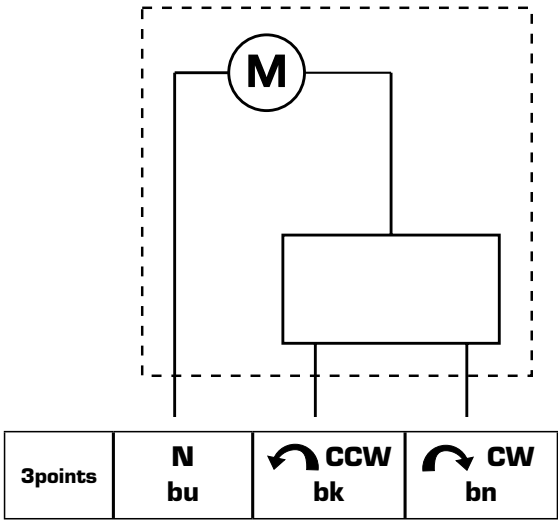

Series ARA6_2, ARA6_4

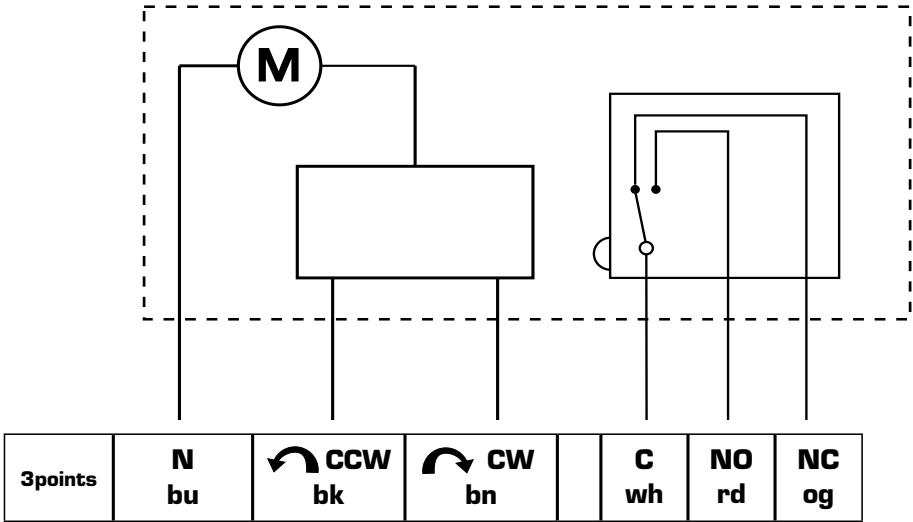

Series ARA6_2, 6_4

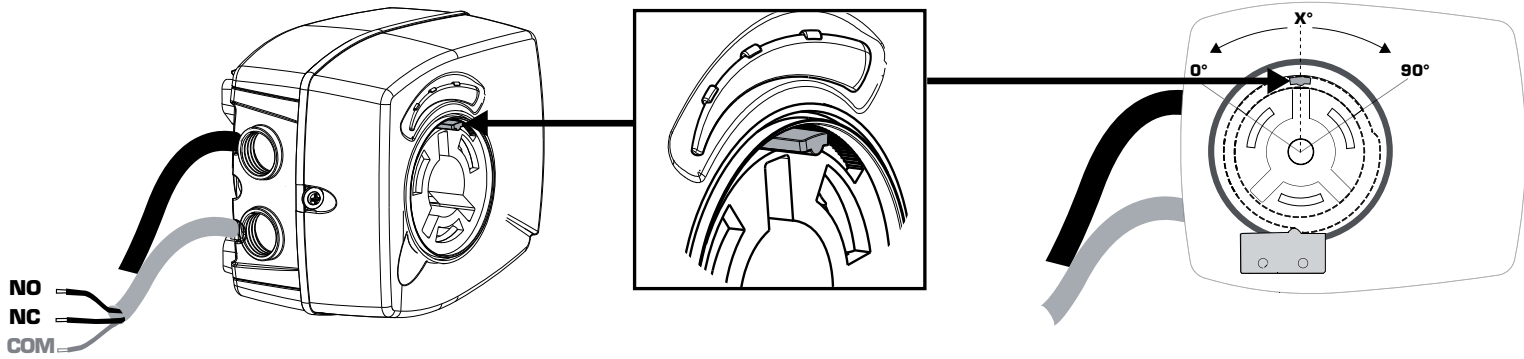

	0° - X°	X° - 90°
NO		
NC		
	X° = 45°	



1



2

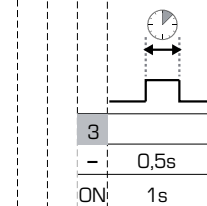
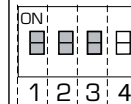
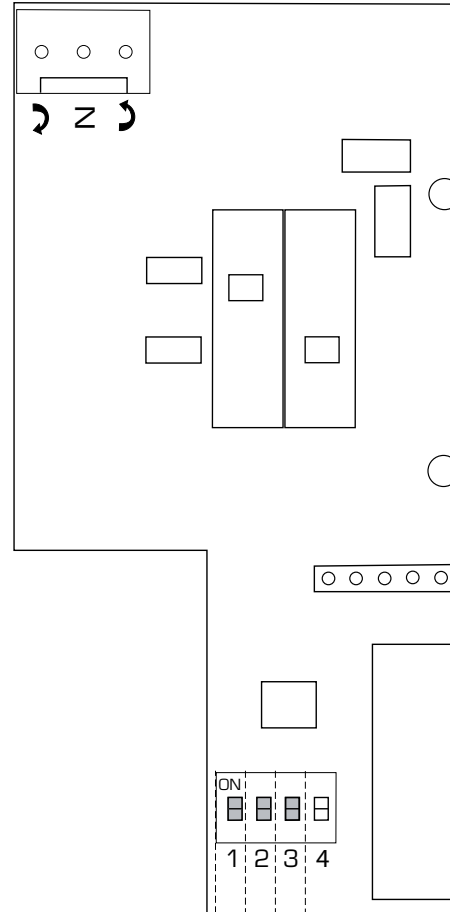
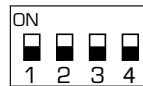
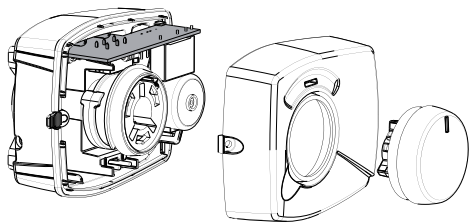
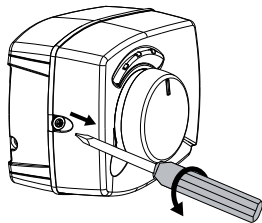

1	2		
-	-		120s
-	ON		240s
ON	-		480s
ON	ON		1200s



2 1

